

UPTON SQUARE

WELLINGTON 3 STOREY 3/4 BEDROOM HOUSE

The imaginative layout of this three-storey house with three or four bedrooms offers lifestyle choices for a couple needing space for a home office, or a growing family requiring the maximum number of bedrooms.

- En suite
- Home office/bedroom
- Numerous storage areas
- Living/dining room



UPTON SQUARE

WELLINGTON 3 STOREY 3/4 BEDROOM HOUSE

TYPICAL LAYOUT

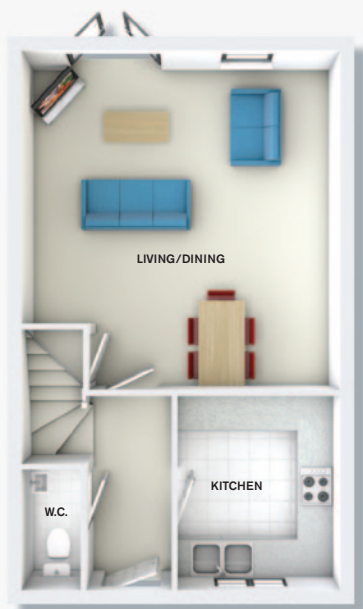

GROUND FLOOR

Living/dining 5.11m x 4.82m* (16'9" x 15'10")
 Kitchen 2.43m x 2.92m (7'12" x 9'7")

TYPICAL LAYOUT

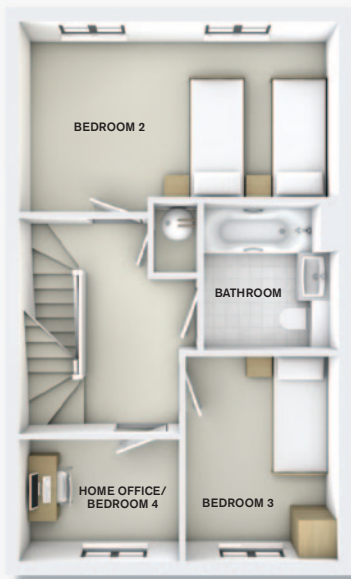

FIRST FLOOR

Bedroom 2 2.86m x 4.80m* (9'5" x 15'9")
 Bedroom 3 3.01m x 2.30m (9'10" x 7'7")
 HO/bedroom 4 2.41m x 1.82m (7'11" x 6'0")

TYPICAL LAYOUT



Total area: 108sqm (1163 sq.ft.)

SECOND FLOOR

Bedroom 1 3.51m x 3.78m (11'6" x 12'5")

*Maximum dimensions shown. Unit widths vary.

Drawings are not to scale. Dimensions, roof styles, elevations and specifications may vary from plot-to-plot. Measurements are approximations only. Imperial measurements are rounded up. Please refer to a sales consultant for more details. Photographs and illustrations depict similarly styled interiors, exteriors and fittings and are provided to give a general representation for the guidance of intending purchasers. Metropolitan Living Limited reserves the right to change details from time-to-time if necessary.

A GREAT DEAL MORE SPACE